



Fat Collection Canister Systems

B89110, B89111, B89116, B89117

Parts included with canister system:

- (1ea) Reusable canister one of three options (B89164, 500cc/B89165, 1000cc/B89166, 2000cc/B89167, 3000cc) with Stainless steel hose barb fitting attached
- (1ea) Reusable canister lid with overflow protection device (B89119)
- (1ea) Reusable silicone tubing with lid coupling piece 6' (B89121)
- (1ea) Reusable silicone "fill tube" with pinch clamp and Toomey syringe connector (B89109)
- (1ea) Reusable silicone "fill tube" with pinch clamp and Luer syringe connector (B89107)
- (1ea) Reusable stainless steel stand one of two options (B89108, B89112)

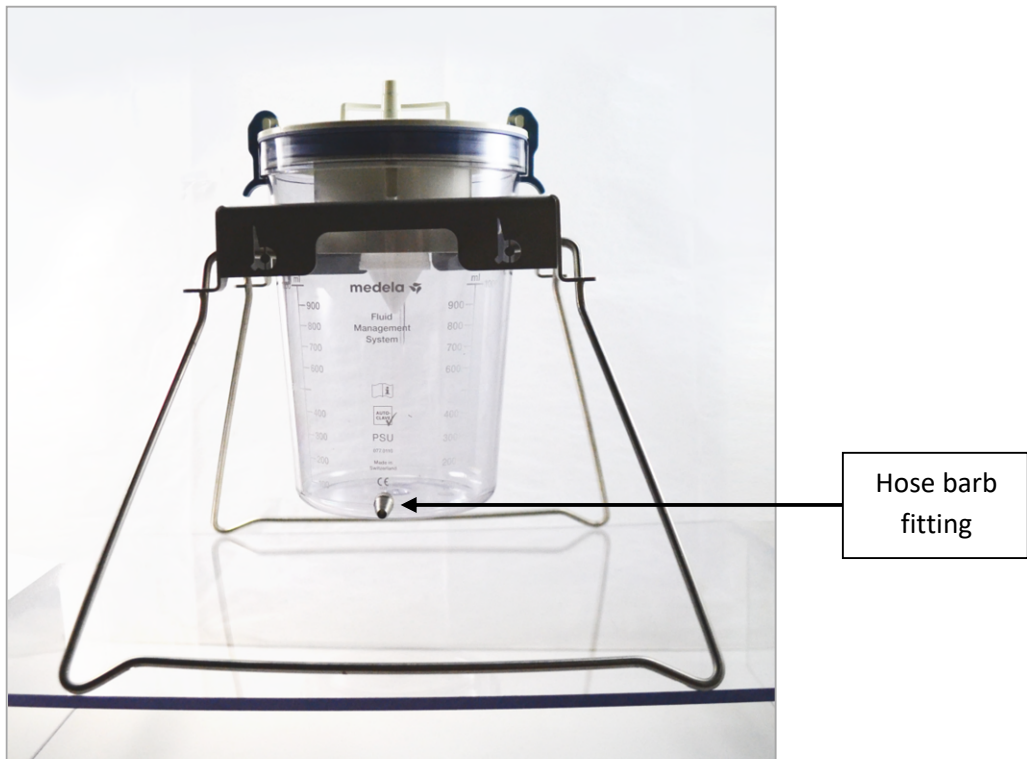

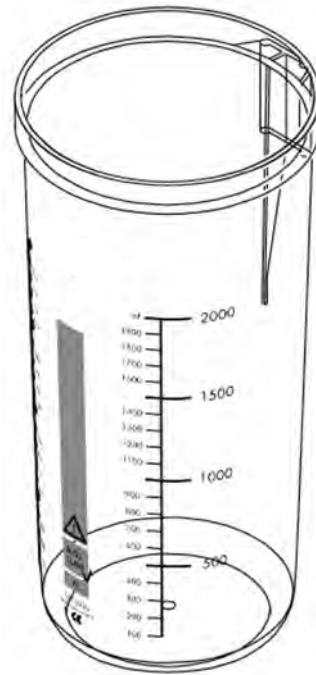
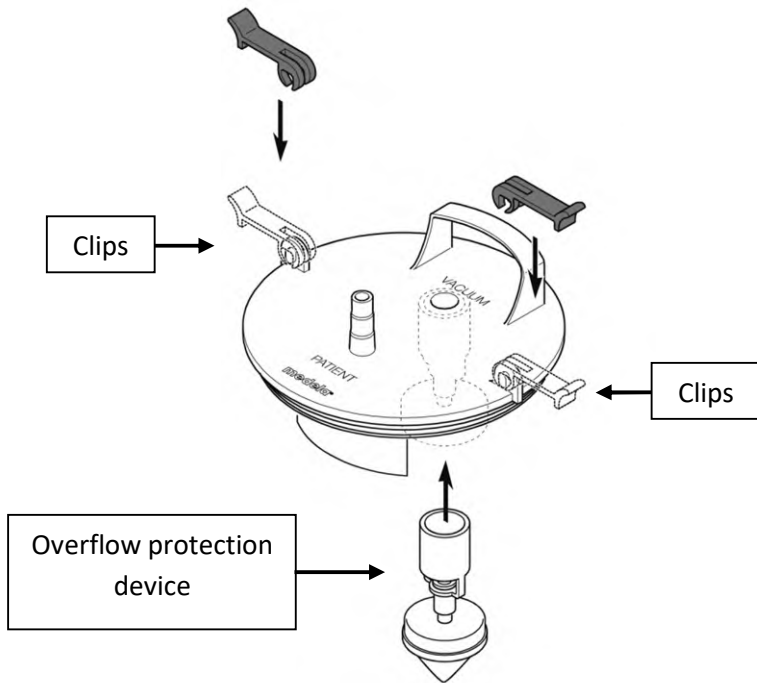

Vacuum assembly tubing with coupling device (B89121)

Toomey syringe connector (B89109)

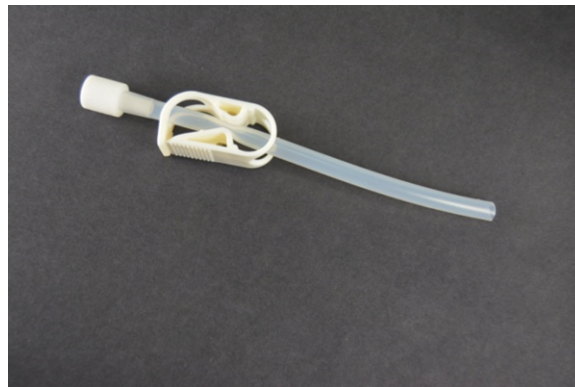

B89109 connected to Toomey syringe

Fill tube assembly (B89107) Luer lock syringe

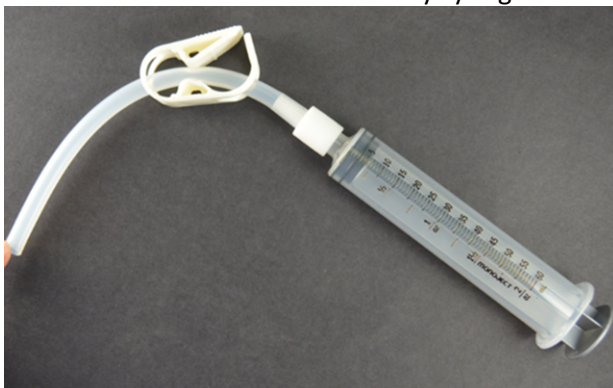

Instructions for use:

Canister & lids are made of Polysulfone (PSU). The canister and lid are shipped “Non-Sterile”, reusable device.

Canisters and lids are made of high-quality plastics. All plastics are subject to a normal aging process, which can be accelerated by mechanical, chemical and thermal processes (e.g. autoclaving). This aging is apparent by discoloration, brittle sections and/or the formation of cracks.

For optimal user-safety, inspect canister and lids before each use. This is done by checking the parts visually and evacuating the canister by using your aspirator with the maximum vacuum used during fat harvesting, typically not more than **-20 HG**. Defective, worn or cracked canisters and lids should **not** be used.

- Remove lid clips and over flow protection device prior to autoclaving, use caution when removing.
- All items must be soaked and ports flushed immediately after use. This will help prevent debris from collecting in the canister.

Cleaning and Sterilization:

1. All items should be cleaned thoroughly of all foreign matter prior to sterilization.
2. Use pH neutral enzymatic cleaner and warm water to clean parts. It is recommended to use a syringe to flush out tubing and all ports.
3. Remove any disinfectant residue before autoclaving. Do not stack during autoclaving.
4. Sterilization parameters:

Method	Moist Heat Sterilization according to ANSI/AAMI ST79
Cycle	Gravity-displacement Steam Sterilizer
Temperature	135°C (275°F)
Exposure Time	10 minutes
Pressure	0.1 to 2.2 bar (2 to 22 psia)
Drying Time	20 minutes (minimum, in chamber)
Cooling Time	20 minutes (minimum, at room temperature)